



Art Clay Original Ring Mold Project

TEXTURE RINGS

MATERIALS

- Art Clay Silver About 10 g
- Art Clay Original Ring Mold
- Oil (cooking oil, etc.) Cotton swabs Water Hair dryer
- Hand towel or stainless spatula Basic tools
- Firing equipment (gas torch, firing tray for stainless steel mesh, electric furnace, etc.)

HOW TO MAKE * Before beginning, lightly moisten your hands.



To make it easier to remove the silver clay, apply a thin layer of oil (cooking oil) to the recessed areas of the mold.

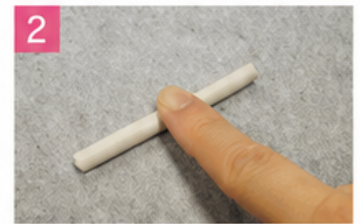

Roll the silver clay into an even cylinder.



Check the thickness using the ring mold instructions as a guide, and roll the clay to approximately that thickness.



Press the clay into the mold so that it fills the texture pattern. Press firmly so it reaches every part of the pattern.

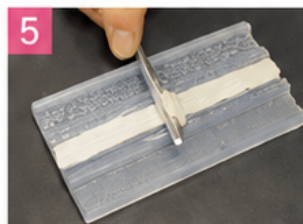

Moisten the surface of the silver clay slightly with water and smooth it with a spatula or similar tool.



Gently bend the mold and slowly peel the clay off. Handle carefully so the texture does not distort.

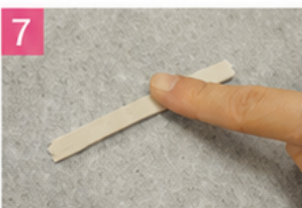

Slightly wet the inside of the ring with a small amount of water.



Wrap the clay around the center of the wooden mandrel. Check the size by sliding on and off the mandrel. This example is size 4.



Remove any excess silver clay with a cutter or similar tool, and apply water to the joint. Press the ends together to secure. Let dry.



Once completely dry, remove the ring from the mandrel and refine the shape of the ring. Use a cutter or fine sand paper to smooth the edges. Handle gently so the ring does not crack.

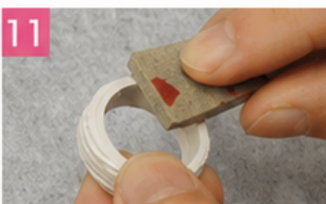

Use a sponge abrasive (#320–#600) to smooth the surface and edges.



Fire the piece, then polish the entire ring with a stainless brush. Finally, use a polishing compound to bring out a brilliant shine.

YOU CAN MAKE MANY DIFFERENT DESIGNS!

By combining different textures and adjusting the width, you can create your own unique rings.

